



25 Bishops Close

, Chepstow, NP16 5TE

£1,050 PCM



Description

* Mid Link Property * Two double bedrooms * Hall * Kitchen with Integrated Single Oven and Grill, 4 Ring Gas Hob with Extractor Over * Bathroom with Mixer Tap Shower * Double Glazed * Gas Central Heating * Enclosed Rear Garden * Off road parking * Available 19th June 2026*

Monthly Rent: £1,050.00

Deposit: £1575.00

Holding Deposit: £242.00

Building Materials: Brick

Sewerage Supply: Mains sewerage

Broadband Coverage: Ofcom - up to 1800mbps

Mobile Coverage: All carriers - Good outdoors / Variable indoors

Utility Supplies: Electrical supply and Gas Heating

Water Supply: Mains

Parking Status: Off road parking

Restrictions - No known restrictions & rights

Material information - any information detailed within our marketing is obtained via the landlord or

Accommodation

HALL

KITCHEN

9'7" Max x 7'6" Max

LIVING/DINING ROOM

14'8" x 11'9"

1ST FLOOR LANDING

5'2" x 3'1"

BEDROOM 1

11'9" x 9'2"

BEDROOM 2

11'9" Max x 8'2" Max

BATHROOM

6'7" x 5'6"

with White Suite Comprising of Side Panel Bath, Wash Hand Basin and Low Level W.C, Extractor Fan, Storage Shelves.

Ground Floor

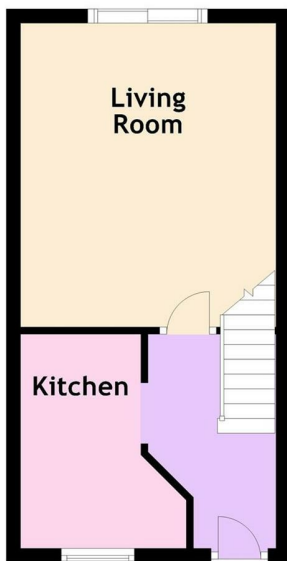

First Floor

